

Memo No. 08/HIDCO/Plng./Plng Area/625(9)/2014

Dated 24/02/2015

To, M/s Ganesh Tracom Private Limited & Others

111, Park Street, 1st Floor,

Kolkata – 700 016

Sub: Land Use Compatibility Certificate

In reference to his/her application dated 19/02/2015 on the subject quoted above, the proposed Institution of **Residential** use/change of use of land from **Agriculture** to **Residence/development** for an area of **42750.26** square meters (Site Plan enclosed) at **New Town Planning Area R.S. Plot Nos. 473 to 480, 481(part), 483, 489 to 497, 499, 500, 501(part), 502(part), 503(part), 504(part), 506(part), 507(part), 509(part), 526(part), 531, 532(part), 533(part), 501/716 (Khatian Nos. 2813, 2820, 2851, 2834, 2821, 2852, 3070, 2831, 2833, 2822, 3340, 3341, 3317, 3301, 3304, 3316, 3305, 2823, 3315, 3237, 2836, 2824, 2839, 3281, 3283, 2832, 2835, 3235, 3233, 3239, 3071, 2853, 2792, 3288, 3265, 3287, 3313, 3318, 3310, 3308, 3309, 3314, 2816, 3234, 2854, 2849, 2848, 2817, 2887, 2855, 2794, 2793, 2795, 2846, 2818, 2803, 2837, 2806, 3303, 3311, 3312, 3302, 2856, 3284, 3240, 3296, 3282, 3286, 2862, 2857, 2845, 2810, 3238, 3136, 3236, 2805, 2802, 3285, 2801, 2858, 2800, 2859, 2844, 2804, 2830, 2843, 2842, 2807, 2865, 2815, 2866, 2829, 2809, 2808, 2814, 2819, 2828, 2811, 2796, 2864, 2827, 2841, 2841, 2840, 2797, 2826, 2838, 2812, 3073, 3072, 2825, 2860, 2863, 2850, 2798, 3307, 2799, 2861, 1250, 756, 2519, 2573, 2088, 682)** in Sheet No. (**only one sheet**) Holding No **X** within Ward No **X** Mouza **Bhatenda** J. L. No. **28** under **Rajarhat** Police Station, he/she is hereby informed that the Development, Institution, Change of use of land as proposed is compatible to the predominant Land Use of the **Residential** Zone No. **I** as per Land Use Map prepared and published by WBHIDCO Ltd. under section **36** of the West Bengal Town & Country (Planning & Development) Act, 1979. The Development Charges as leviable under the said Act for the proposed Institution & change of use of land has been paid vide money receipt no **9992** dated 19/02/2015.

WEST BENGAL HOUSING INFRASTRUCTURE DEVELOPMENT CORPORATION LTD.

(A Govt. of West Bengal Undertaking)

“HIDCO BHABAN”, Premises No.: 35 - 1111, Major Arterial Road, 3rd Rotary, New Town, Kolkata-700156
 Telephone : (033) 2324-6037/6038, Fax No. : (033) 2324-3016/6009, e-mail : housing@cal2.vsnl.net.in / wbhidcoltd@gmail.com,
 Website : www.wbhidcoltd.com



The New Town Kolkata Planning Area (Building) Rules 2014 is applicable for development of those buildings of the planning area consistent with LUDCP with height more than 15 meter and / or with plot area above 1 hectare. For development permission in such cases No Objection Certificate (NOC) would have to be obtained from NKDA, as per provisions u/s 24 (Note) of NTK Planning Area (Building) Rules 2014.

Chief Planner, WBHIDCO
P. B. Bhattacharya
Chief Planner

W. B. Housing Infrastructure Development Corporation Ltd.
"HIDCO BHABAN" 35-1111, Major Arterial Road
3rd Rotary, New Town, Kolkata-700156

WEST BENGAL HOUSING INFRASTRUCTURE DEVELOPMENT CORPORATION LTD.

(A Govt. of West Bengal Undertaking)

"HIDCO BHABAN", Premises No.: 35 - 1111, Major Arterial Road, 3rd Rotary, New Town, Kolkata-700156
Telephone : (033) 2324-6037/6038, Fax No. : (033) 2324-3016/6009, e-mail : housing@cal2.vsnl.net.in / wbhidcoltd@gmail.com,
Website : www.wbhidcoltd.com

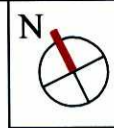

NAME OF OWNER
1. ALISHAN SUPPLY PRIVATE LIMITED
2. ADYA REAL ESTATES PRIVATE LIMITED
3. ANCHOR VANIYA PRIVATE LIMITED
4. ANTRATMA ADVISORY PRIVATE LIMITED
5. ANTRATMA DEALERS PRIVATE LIMITED
6. ANUKARAN SUPPLY PRIVATE LIMITED
7. ARAVALIHIRISE PRIVATE LIMITED
8. ARCH VANIYA PRIVATE LIMITED
9. ARPANA CONSULTANCY PRIVATE LIMITED
10. ARPANA TIE UP PRIVATE LIMITED
11. ARTLINE HOMES PRIVATE LIMITED
12. ARTLINE PROJECTS PRIVATE LIMITED
13. ARTLINE REAL ESTATE PVT LTD
14. AVERAGE COMPLEX PRIVATE LIMITED
15. AVERAGE HOUSING PRIVATE LIMITED
16. AVERAGE INFRACON PRIVATE LIMITED
17. AVERAGE NIRMAN PRIVATE LIMITED
18. AVERAGE PROJECTS PRIVATE LIMITED
19. BASUDEB HOUSING PRIVATE LIMITED
20. BLUEBIRD TIE UP PRIVATE LIMITED
21. BOOSTER HEIGHTS PRIVATE LIMITED
22. BOOSTER HIRISE PRIVATE LIMITED
23. BRIJHUMI AGENTS PRIVATE LIMITED
24. BRIJHUMI TIE UP PRIVATE LIMITED
25. CITYWINGSVYAPAAR PRIVATE LIMITED
26. CROSSWAY HEIGHTS PRIVATE LIMITED
27. CROSSWAY NIRMAN PRIVATE LIMITED
28. DAYANIDHI SUPPLIERS PRIVATE LIMITED
29. DELTA VYAPAAR PRIVATE LIMITED
30. DHANGANGA HIRISE PRIVATE LIMITED
31. DHANGANGA INFRACON PRIVATE LIMITED
32. DHANGANGA REALTY PRIVATE LIMITED
33. DREAMLAND HIRISE PRIVATE LIMITED
34. ELEGANT NIRMAN PRIVATE LIMITED
35. GABDANVINIMAY PRIVATE LIMITED
36. GAGAMINI BUILDCON PRIVATE LIMITED
37. GAGAMINI CONSTRUCTIONS PRIVATE LIMITED
38. GAGAMINI REALTY PRIVATE LIMITED
39. GAJMUKHI ENCLAVE PRIVATE LIMITED
40. GAJMUKHI HOMES PRIVATE LIMITED
41. GAJMUKHI INFRACON PRIVATE LIMITED
42. GAJMUKHI NIRMAN PRIVATE LIMITED
43. GAJMUKHI PROJECTS PRIVATE LIMITED
44. GAJMUKHI REAL ESTATE PRIVATE LIMITED
45. GANESH TRACOM PRIVATE LIMITED
46. GANESHVANI PROMOTERS PRIVATE LIMITED
47. GREEN TOP NIRMAN PRIVATE LIMITED
48. GUIDANCE VYAPAAR PRIVATE LIMITED
49. GULLMARG VYAPAAR PRIVATE LIMITED
50. HANURANG TIE UP PRIVATE LIMITED
51. INDIVARTRACOM PRIVATE LIMITED
52. JAJINENDRA DISTRIBUTORS PRIVATE LIMITED
53. JAJINENDRA MARKETING PRIVATE LIMITED
54. JAJINENDRA MERCHANTS PRIVATE LIMITED
55. JALDHAM ADVISORY PRIVATE LIMITED
56. JALDHAM TIE UP PRIVATE LIMITED
57. JHILMIL SALES PRIVATE LIMITED
58. JHILMIL VYAPAAR PRIVATE LIMITED
59. JINAY MERCHANTS PRIVATE LIMITED
60. JUHI MARKETING PRIVATE LIMITED
61. KALAKRITI ENCLAVE PRIVATE LIMITED
62. KALAKRITI HOMES PRIVATE LIMITED
63. KALAKRITI HOUSING PRIVATE LIMITED
64. KALAKRITI REALTY PRIVATE LIMITED
65. KAMYABI CONSULTANTS PRIVATE LIMITED
66. LIFE LONG ENCLAVE PRIVATE LIMITED
67. DHANGANGA RESIDENCY PRIVATE LIMITED
68. LINK ROSE CONSTRUCTIONS PRIVATE LIMITED
69. LINK ROSE HOUSING PRIVATE LIMITED
70. LINK ROSE RESIDENCY PRIVATE LIMITED
71. MANOBAL DEALER PRIVATE LIMITED
72. MANOBAL VANIYA PRIVATE LIMITED
73. MATRIX SALES PRIVATE LIMITED
74. MAXFLOW BARTER PRIVATE LIMITED
75. MOONLIFE CONSTRUCTIONS PRIVATE LIMITED
76. MOONLIFE NIRMAN PRIVATE LIMITED
77. MOONLIFE RESIDENCY PRIVATE LIMITED
78. MRIDUL ADVISORY PRIVATE LIMITED
79. NEW WAVE MERCHANTS PRIVATE LIMITED
80. ORIGINAL REALTY PRIVATE LIMITED
81. PANGHAT SUPPLY PRIVATE LIMITED
82. PAWANPUTRA BARTER PRIVATE LIMITED
83. PAWANPUTRA SALES PRIVATE LIMITED
84. PRABHAKAR BARTER PRIVATE LIMITED
85. PRAJAPATI COMMERCIAL PRIVATE LIMITED
86. PRAJAPATI DEALER PRIVATE LIMITED
87. PREMSAGAR ADVISORY PRIVATE LIMITED
88. PREMSAGAR TIE UP PRIVATE LIMITED
89. PRIME ROSE MARKETING PRIVATE LIMITED
90. RIMJHM COMMODITIES PRIVATE LIMITED
91. ROSEMARY DISTRIBUTORS PRIVATE LIMITED
92. ROSEMARY TIE UP PRIVATE LIMITED
93. SADABAHAR VYAPAAR PRIVATE LIMITED
94. SAGUN ADVISORY SERVICES PRIVATE LIMITED
95. SANJIVAN VANIYA PRIVATE LIMITED
96. SARGAM VYAPAAR PRIVATE LIMITED
97. SAWARG VANIYA PRIVATE LIMITED
98. SHIVASTHAL DEALERS PRIVATE LIMITED
99. SHIVASTHAL SALES PRIVATE LIMITED
100. SIDDHA STYLE BARTER PRIVATE LIMITED
101. SIDHANT SUPPLIERS PRIVATE LIMITED
102. SILVERLINE VINIMAY PRIVATE LIMITED
103. SKYLINK MERCHANTS PRIVATE LIMITED
104. SPANDAN SUPPLIERS PRIVATE LIMITED
105. SPLENDOR VYAPAAR PRIVATE LIMITED
106. STYLE MERCHANTS PRIVATE LIMITED
107. SUKHIT VYAPAAR PRIVATE LIMITED
108. SUNMART VYAPAAR PRIVATE LIMITED
109. SUNSHINE BARTER PRIVATE LIMITED
110. SUPERIOR COMPLEX PVT LTD.
111. SUPERIOR HIRISE PVT LTD.
112. SURDHUNI ADVISORY PRIVATE LIMITED
113. SURSARITA ADVISORY SERVICES PRIVATE LIMITED
114. SURSARITA CONSULTANTS PRIVATE LIMITED
115. SWASTIK BARTER PRIVATE LIMITED
116. TERAPANTH CONSULTANCY SERVICES PVT. LTD.
117. TIMELESS REAL ESTATE PRIVATE LIMITED
118. TOPTENVYAPAAR PRIVATE LIMITED
119. VIDHATA ADVISORY SERVICES PRIVATE LIMITED
120. KALAKRITI PROPERTIES PRIVATE LIMITED.

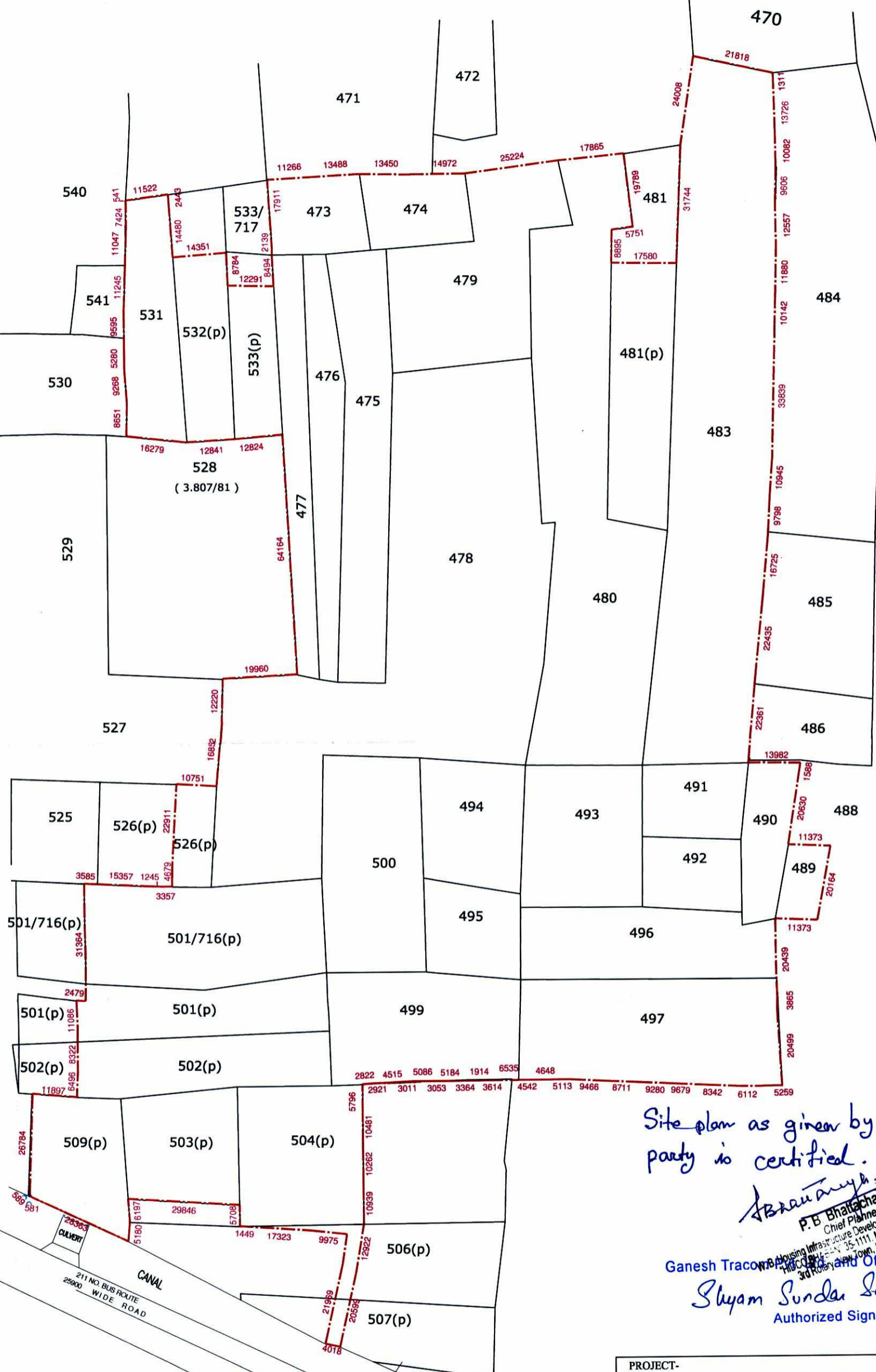

Site plan as given by the party is certified.

(Signature)
P.B. Bhattacharya
 Chief Planner
 Ganesh Tracoms Housing Infrastructure Development Corporation Ltd.
 35-1111, Major Arterial Road
 3rd Rotary, New Town, Kolkata-700156
Shyam Sunder Saha
 Authorized Signatory

PROJECT-
 SITE PLAN OF MOUZA- BHATENDA, R.S.DAG NOS.473,474, 475,476,477,478,479, 480, 481(P),483, 489, 490, 491, 492,493, 494, 495, 496, 497, 499, 500, 501(P), 502(P), 503(P), 504(P), 506(P),507(P), 509(P), 526(P),531, 532(P),533(P),501/716 RECORDED IN L.R.KHATIANNOS.2813, 2820, 2851, 2834, 2821, 2852, 3070, 2831, 2833, 2822, 3340, 3341, 3317, 3301, 3304, 3316, 3305, 2823, 3315, 3237, 2836, 2824, 2839, 3281, 3283, 2832, 2835, 3235, 3233, 3239, 3071, 2853, 2792, 3288, 3265, 3287, 3313, 3318, 3310, 3308, 3309, 3314, 2816, 3234, 2854, 2849, 2848, 2817, 2887, 2855, 2794, 2793, 2795, 2846, 2818, 2803, 2837, 2806, 3303, 3311, 3312, 3302, 2856, 3284, 3240, 3296, 3282, 3286, 2862, 2857, 2845, 2810, 3238, 3136, 3236, 2805, 2802, 3285, 2801,2858,2800, 2859,2844, 2804, 2830, 2843, 2842, 2807, 2865, 2815, 2866, 2829, 2809, 2808, 2814, 2819, 2828, 2811, 2796, 2864, 2827, 2841, 2840, 2797, 2826, 2838, 2812, 3073, 3072, 2825, 2860, 2863, 2850, 2798, 3307, 2799, 2861, 1250,756,2519,2573,2088,682, MOUZA-BHATENDA, I.L. NO. 28, POLICE STATION RAJARHAT, WITHIN THE JURISDICTION OF RAJARHAT BISHNUPUR NO. 1 GRAM PANCHAYAT, DISTRICT- NORTH 24 PARGANAS

DR. SUJIT KUMAR BOSE
 Ph.D., M.C.E (Soil) B.C.E. (Hons)
 MIGS
 License No:- BM / Geo -Tech /17

JAY PRAKASH BHARAT KUMAR AGRAWAL
 B. Arch., A.I.I.A.
 Reg. No. CA / 86 / 1098
 ARCHITECT SL. NO. - 32(A)
 SIGNATURE OF ARCHITECT
 TITLE: SITE PLAN Date: 04/02/2015